

# Tower of Strength Ministries

Proverbs 18:10

## MULTI-PURPOSE BUILDING: 1st Floor: Cafeteria / Commercial Kitchen / Security



FRONT ELEVATION (approx. 96'us.ft. / ±112' including stairwells)

The community can enjoy meals together on occasion in this 100 seat cafeteria, served by a large commercial size kitchen with serving counter. The pantry, storage, and walk-in cooler provides ample ability to stock food not just for the community, but the local population as well.

Folding partitions can be deployed to create additional classroom space, as needed.

The security and overseer's offices have immediate access to the cafeteria as well as clear views of the front gate, parking, and driveway.



EAST ELEVATION (approx. 52'us.ft. / ±69' with porches)

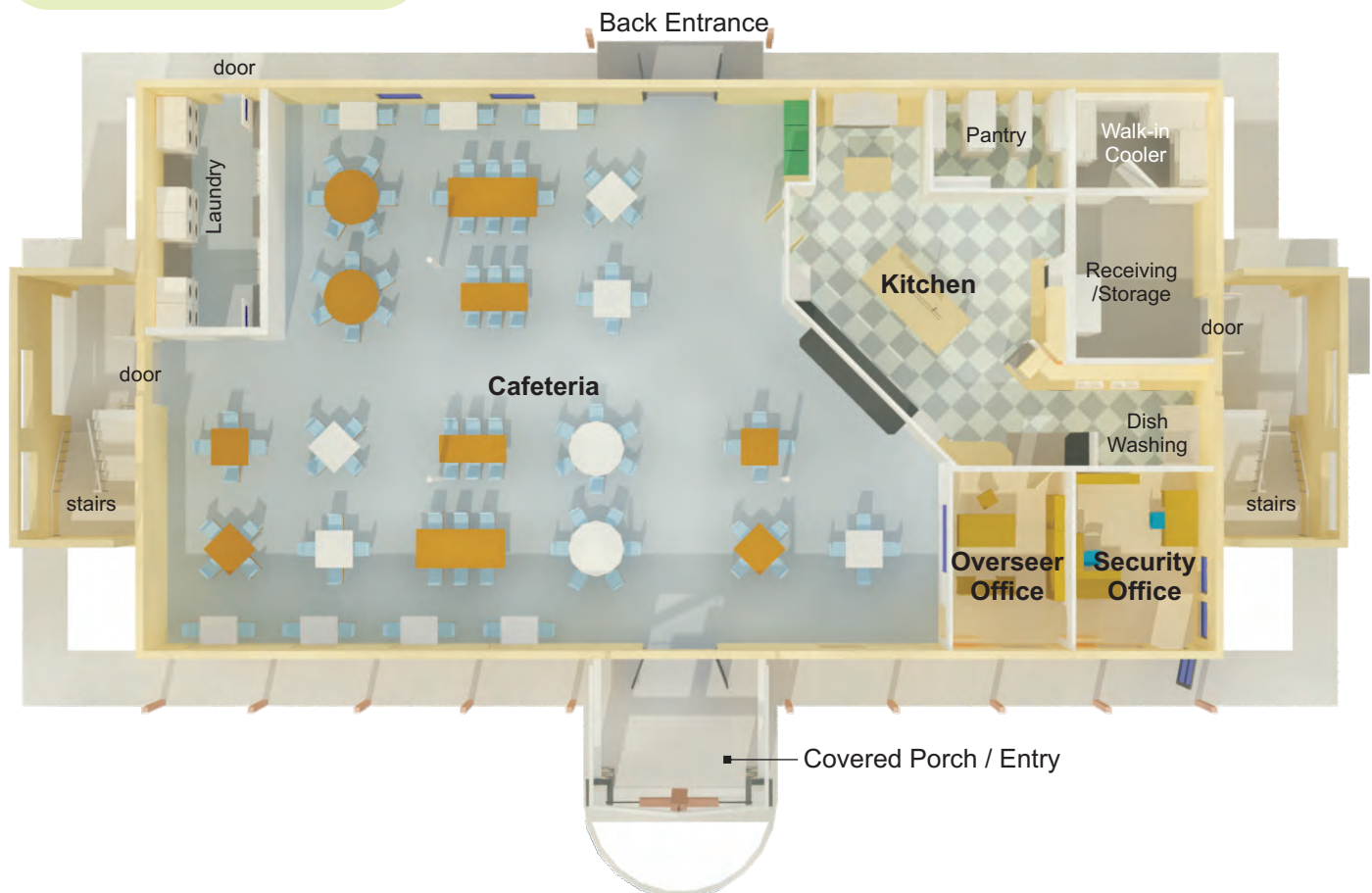

# Tower of Strength Ministries

Proverbs 18:10

## MULTI-PURPOSE BUILDING: 2nd Floor: Living and Guest Quarters



BACK ELEVATION



WEST ELEVATION

The upstairs of the building provides 6 dormitory style rooms and shared bathroom facilities with total accommodations for 22+ depending on bedding configurations.

The future space may be developed as living quarters for the community overseer, volunteer fellowship space, additional dorms, or a combination of these elements.

